

A1

INTEGRATED CLASS A AMPLIFIER

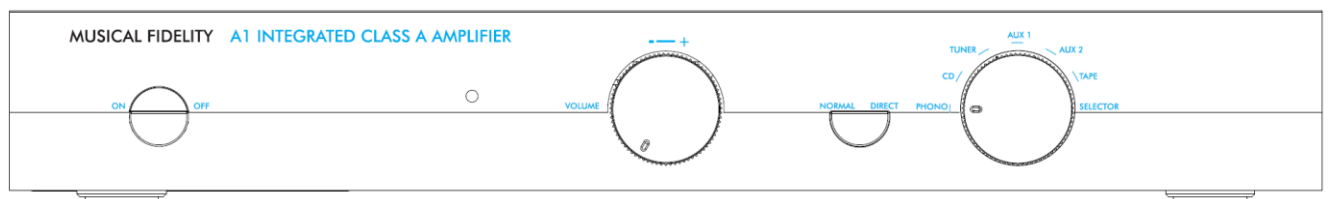

Instructions for use

Thank you for choosing the A1 integrated class A amplifier. Used properly, it should give you many years of outstanding musical reproduction.

The A1 is designed for high definition performance. It is strongly biased into Class A, for audible smoothness and clarity.

If there are any questions about the audio system, please consult the dealer, who is there to help and advise.

HEAT DISSIPATION

The A1 is a traditional Class A amp. A rarity in this day and age. Because the A1 is strongly biased into Class A, it dissipates power, as heat. Think of the heat that a 75 watt light bulb creates, and you've got an idea of the heat produced by the A1.

CAUTION:

SOME PARTS OF THE PRODUCT MAY BECOME VERY HOT AND CAUSE BURNS. SPECIAL CARE SHOULD BE TAKEN IN THE PRESENCE OF CHILDREN AND VULNERABLE PERSONS.

THE WHOLE TOP OF THE A1 IS A HEAT SINK. TO ALLOW FULL HEAT DISSIPATION, NOTHING SHOULD BE PLACED ON IT AT ANY TIME. SURFACE TEMPERATURES OF ABOUT 55 DEGREES C ARE AVERAGE FOR THE HEAT SINK. FRONT PANEL CONTROL ELEMENTS CAN FEEL WARM TO THE TOUCH.

The exact temperature depends on the ambient temperature in your room, and on how much energy is dissipated as sound.

It is also important to keep the top of the A1 free of dust and grime. Dust it regularly with a soft duster or soft brush but do not use cleaning or polishing agents - they may harm the surface finish.

| Section | | Page |
|-----------------------------------|--|------|
| Safety Information | – Mains plug (UK only), modification warning | 3 |
| General advice | – Installation precautions | 4 |
| Installation | – Introduction, cleaning, installation, power connections, audio connections | 5 |
| Facilities and connections | – Illustrations, main unit front & rear panels | 6 |
| Remote control handset | – Operation and illustration | 7 |
| Operation | – Starting | 8 |
| | – Fuses | |
| | – Volume | |
| | – Mute (Remote Control only) | |
| | – Input Selection | |
| | – NORMAL/DIRECT | |
| | – Wiring | 9 |
| Problems? | – Basic fault finding | 10 |
| Specifications | – Product specifications | 11 |
| Manual history | | 12 |
| Item disposal information | | |

IMPORTANT! (U.K. only)

This unit is supplied in the U.K. with mains lead fitted with a moulded 10 amp plug. If, for any reason, it is necessary to remove the plug, please remove the fuse holder and dispose of the plug safely, out of reach of children.

It must not be plugged into a mains outlet.

The wires in the mains lead supplied with this appliance are coloured in accordance with the following code:

Green and yellow Earth
Blue Neutral
Brown Live

WARNING – This appliance MUST be earthed

As the colours of the wires of the mains lead of this appliance may not correspond with the coloured markings identifying the terminals in the plug, proceed as follows:

- The wire which is coloured green-and-yellow must be connected to the terminal in the plug which is marked with the letter E or coloured green or green-and-yellow, or by the earth symbol: 
 - The wire which is coloured brown must be connected to the terminal which is marked with the letter L or coloured red.
 - The wire which is coloured blue must be connected to the terminal which is marked with the letter N or coloured black.
 - If connecting to a BS1363 plug, a 13 amp fuse must be used.
-

WARNING:

ANY MODIFICATIONS TO THIS PRODUCT NOT EXPRESSLY APPROVED BY MUSICAL FIDELITY WHO IS THE PARTY RESPONSIBLE FOR STANDARDS COMPLIANCE COULD VOID THE USER'S AUTHORITY TO OPERATE THIS EQUIPMENT.

Installation, Precautions & User Information

Your new A1 is designed and built to provide trouble-free performance but it is necessary to observe a few precautions. Please ensure that you have complied with them before you connect any AC power to your amplifier. Retain this guide for future reference.

- Heed all warnings on the back of the amplifier.
- Only connect the A1 to a mains outlet having the same voltage as marked at the back of the unit.
- All connections should be made with the power OFF.
- Position the mains lead and signal interconnects where they are not likely to be walked on or trapped by items placed on them.
- Do not use near water, or place water-filled containers or any other containers or objects on the A1, for example, a flower vase, potted plants, or other audio equipment. **If water does spill inside, immediately pull out the mains plug from the wall socket and inform your dealer, who should then check the unit before further use. Entry of liquid into the A1 is dangerous, and may cause electric shock or fire hazard.**
- Do not place the unit near direct heat sources such as radiators, direct sunlight or other equipment.
- Only place it where there is room for adequate ventilation around it.
- Do not remove any covers or try to gain access to the inside. There are no internal adjustments or fuses you can replace yourself. Refer all service work to an authorised Musical Fidelity agent.
*** Note: Unauthorised opening of the equipment will invalidate any warranty claim.**
- Dust regularly with a soft cloth or soft brush but be careful when using cleaning or polishing agents - they may harm the surface finish.

The electronics in modern hi-fi equipment is complex and may, therefore, be adversely affected or damaged by lightning. For protection of the audio system during electrical storms, remove the mains plugs.

If after-sales service is required, to help the dealer identify the A1, please quote the serial number located on the rear panel of the unit.

Introduction

Congratulations on the purchase of the new A1 Integrated Class A Amplifier. Great attention has been paid to revive this classic Musical Fidelity amplifier and bring it to a new generation.

Cleaning

Before cleaning the unit, switch off power at the mains switch and remove the mains plug from the wall socket. Leave the A1 enough time so it can cool down if necessary. Clean the cabinet and remote control unit using a moist cloth. Using solvents, white spirit or thinners is not advised, as they could damage the surface finish.

Installation

Position the A1 on a stable, horizontal surface where there is no risk of it being knocked, or subjected to vibration such as from loudspeakers.

IMPORTANT NOTE:

Because the A1 is strongly biased into Class A, it dissipates power, as heat. A surface temperature of about 55 - 65 degrees C is average for the heat sink in a room where the ambient temperature is about 20 degrees C. Front panel control elements can feel warm to the touch. The exact temperature depends on the ambient temperature in your room, and on how much energy is dissipated as sound.

THERE MUST BE AT LEAST 50MM OF CLEAR SPACE BEHIND, AND AT LEAST 250MM CLEAR SPACE ABOVE THE A1.

THE WHOLE TOP OF THE A1 IS A HEAT SINK. TO ALLOW FULL HEAT DISSIPATION, NOTHING SHOULD BE PLACED ON IT AT ANY TIME.

The A1 must be protected from humidity – if the unit is moved from a cold place to a warm room, leave the unit for an hour or so to allow sufficient time for the moisture to evaporate.

Power Connections

The A1 is supplied with a standard IEC mains cable which plugs into the IEC socket at the back of the unit (see page 6).

Audio Connections

Phono Input: Connect a turntable phono source to the **PHONO RCA** input and set the (see page 6 for more information). Use a good quality fully connected (signal and ground) phono RCA cable (even better is semi-symmetrical and lowest possible capacitance). Connect the ground wire to the ground post. Take care with positioning all input leads, try to ensure that they are well shielded and kept as far away from mains and speaker leads as possible. Set the **MM/MC** switch depending on whether your turntable is equipped with an MM or MC cartridge.

Line Level RCA Inputs: Connect all RCA single-ended line level sources to relevant analogue inputs (see page 6 for more information). Use good quality fully connected (signal and ground) coaxial phono cables for all RCA signal connections. Take care with positioning all input leads, try to ensure that they are well shielded and kept as far away from mains and speaker leads as possible.

Speaker Outputs: Connect loudspeakers to the terminals on the back panel marked as **LEFT** and **RIGHT SPEAKER** outputs. See "WIRING" P.9 for more details.

TAPE OUT output sockets allow loop through of analogue signals for example, to pass on to a recorder or monitor. It is also the ideal output to connect headphone amps into (headphone amplifier will require its own volume control to allow listening level adjustment). This output is the currently selected source but level is *not* changed by the front panel volume control.

PRE OUT output sockets allow analogue signals controlled by the volume, to pass on to, for example, an external power amplifier. This is useful for bi-amping or active "subwoofer" connection where volume out needs to be controlled by the A1 front panel volume control.

A1 INTEGRATED CLASS A AMPLIFIER FACILITIES & CONNECTIONS

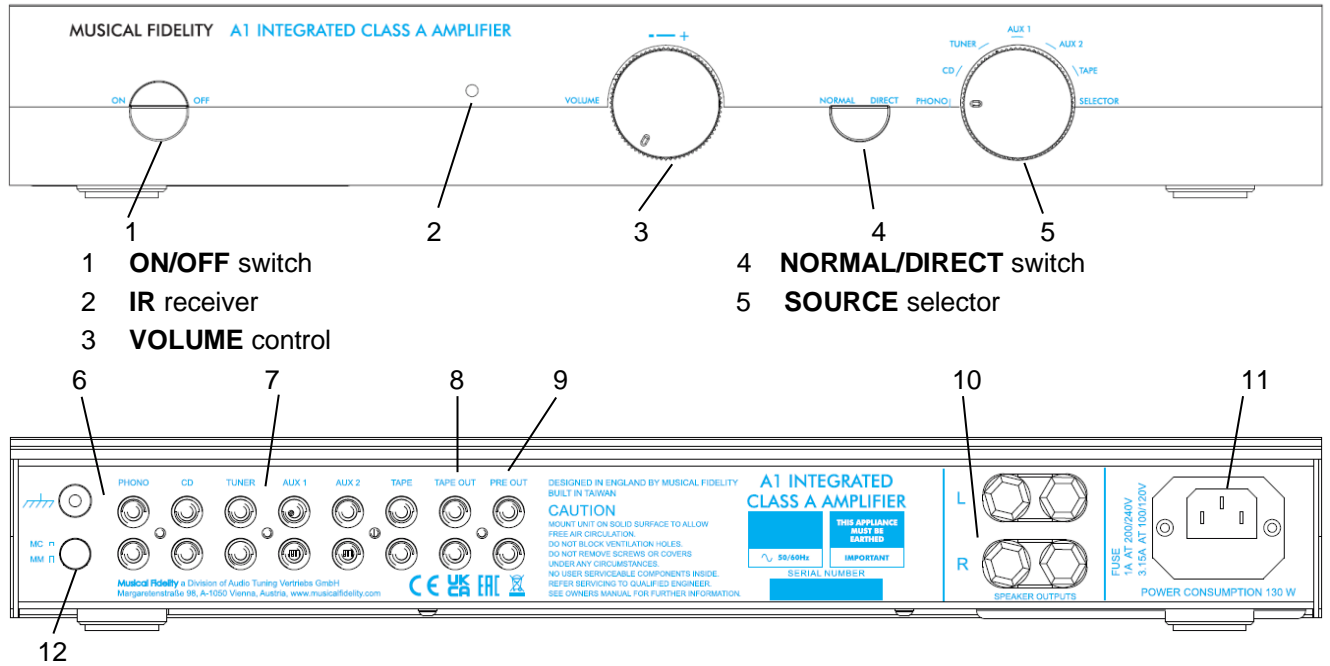

- 1 **ON/OFF** switch
- 2 **IR** receiver
- 3 **VOLUME** control

- 4 **NORMAL/DIRECT** switch
- 5 **SOURCE** selector

- 6 **PHONO** RCA input with ground post
- 7 **RCA** line level input sockets
- 8 **TAPE OUT** fixed output RCA sockets

- 9 **PRE OUT** variable output RCA sockets
- 10 **LOUDSPEAKER OUTPUTS** left and right
- 11 **IEC MAINS INPUT**
- 12 **MM/MC** phono preamp switch

The universal remote control shown below enables functions from this and related units to be operated from a convenient distance.

Equivalent buttons on the remote control have the same functions as those on the front panel of the unit. Mute is only available by remote control. ON/OFF, source selection and normal/direct are not available by remote control. As the handset uses an invisible infra-red light beam, the front edge must be pointed directly towards the receiver window at the front of the player, without visual obstruction between them.

If the range of the remote control greatly decreases, replace the battery with a new one. Use a CR2032 battery only.

Please dispose of used batteries in accordance to local regulations.

VOL + – increases amplifier volume

VOL - – reduces amplifier volume

MUTE – mutes speaker outputs (until pressed again).



Starting

Follow this routine before you listen for the first time, and each time you change any connections.

Check all inputs and outputs to the A1. Then check again. Turn the volume control to nil. Now you can switch on the unit, using the **ON/OFF** switch on the front panel. The ON/OFF, volume and source selector LEDs will light up blue. Carefully advance the volume to the level you want, if all is well, enjoy the music.

Fuses

There is one fuse inside the A1. In the unlikely event that it blows, take your A1 to your audio dealer. Do NOT try to replace the fuse yourself or you will invalidate the warranty.

Volume

The volume should be adjusted for normal listening levels. This is done by turning the volume up/down knob on the front panel.

Adjusting the volume can also be achieved by pressing the volume +/- buttons on the remote control handset (see page 7).

Mute (Remote Control only)

The sound from the speakers may be muted by use of the **MUTE** button on the remote (see page 7).

Press once to mute. No sound will be heard from the speakers. The LED on the volume selector will turn off to indicate the A1 is muted.

To return to listening; simply press the **MUTE** button again.

Input Selection

Connect your sources to the relevant inputs on the back panel (see pages 5 and 6).

Select the desired input by rotating the source selector.

Phono

The unit accepts moving magnet (MM) or moving coil (MC) cartridge inputs through the **PHONO RCA** input sockets. The **MM/MC** switch selects Phono input RCA socket parameters for cartridge type being used:

MC: switch in, higher gain and lower input impedance suitable for low to medium (<100µV to approximately 800µV) output MC cartridges.

MM: switch out, high gain, higher input impedance suitable for MM and high output (greater than approx. 800µV) MC cartridges*.

Warning: While the best efforts have been made to keep switchover artefacts to a minimum, the MM/MC switch operates at the beginning of an amplification chain of more than 80dB (10,000 times). For this reason, it is recommended the MM/MC switch is only operated when volume is turned to minimum, or with any other input (not phono) selected to prevent loud thumps in speakers.

Do NOT connect any external phono preamplifiers to the **PHONO RCA** inputs. Excessive amplification and distortion will result. For external phono preamplifiers use one of the **LINE LEVEL RCA** inputs.

*High output MC cartridges may be used on either MM or MC setting – simply use the one that sounds the best.

Normal/Direct

The **NORMAL/DIRECT** switch bypasses the preamp gain stage:

NORMAL: switch in, preamp gain stage active

DIRECT: switch out, preamp gain stage bypassed resulting in -10dB gain

Use this to fine tune the range of your volume control. Depending on whether you have modern digital sources or traditional analogue sources, sensitive or insensitive speakers you can find your sweet spot.

Simple speaker lead wiring



(source and mains leads omitted for clarity)

Speaker lead wiring with bass/treble terminals

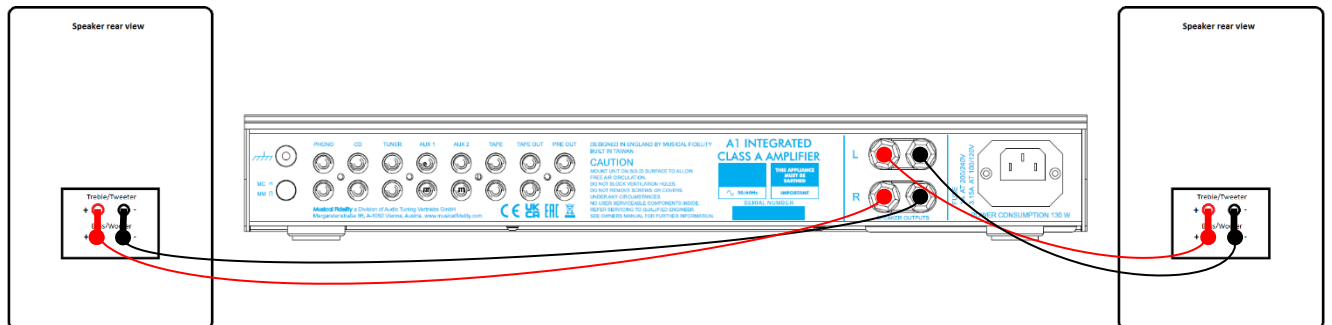

Bass/treble terminal links in

(source and mains leads omitted for clarity)

Bass/treble terminal links in

Basic problem-solving with an amplifier is similar to troubleshooting other electrical or electronic equipment. Always check the most obvious possible causes first, such as the following examples:

| Problem | Probable Cause | Remedy |
|---|---|---|
| No power when POWER button is pressed. | Mains power plug is not fully inserted into rear socket. | Plug in securely. |
| No sound | Mute function is still active. Wrong connections between input sources and the unit Speakers not connected, or incorrectly wired | Press the MUTE button on the remote control to cancel. Check audio input lead connections. Check speaker cables. |
| Sound cut | Loose connection Output overload or short circuit | Check speaker and input connections. Switch unit off. Check speaker connections for shorting strands or wires. When all has been double-checked reduce volume and switch unit back on. N.B. Take great care when bi-wiring or bi-amping that speaker bass and treble linking straps are removed; see speaker manual for more information. |
| Sound is not precise, lacking in bass and stereo image. | Speakers are connected out of phase, i.e., connections to one speaker (+ and -) are reversed. | Ensure speakers are connected with same polarity at amplifier and speaker ends. |
| Hum. | Audio connector plug not fully pushed in Cable Fault Unsuitable cable (e.g. cable grounds not connected) | Insert plug securely. Check cable is connected at both ends. N.B. Some esoteric cables have internal wiring intentionally disconnected/modified. For best results on all inputs analogue AND digital, please use good quality screened coax; signal and screens both separately connected at both ends. |
| No audio output, or too low level output. | Incorrect or missing connections | Check connections and make sure they are secure. |
| Remote control does not work. | Amplifier's POWER off. Battery fitted the wrong way. Battery is flat. Remote control is not pointed directly towards the front panel of the amplifier. Interference from another source. | Switch on. Insert battery correctly. Change battery for a new one. Ensure there is no obstruction between the remote control and amplifier front. Lighting such as fluorescent, incandescent, or even sunlight contains large amounts of infra-red radiation. Ensure such sources are not shining directly on the infra-red window as this could swamp the signal from the remote control. Also check the system and any other nearby remotes for stuck buttons. |
| Remote control range has greatly reduced | Battery is running out | Change battery for a new one. |

If none of these actions affect a cure, please contact the dealer, or an authorised Musical Fidelity service agent. Remember; never open the case of the A1, as this will invalidate the guarantee.

Output

| | |
|-------------------|--|
| Power | 25 Watts per channel into 8 Ohms |
| Voltage | 42.5 Volts peak to peak |
| Current | 25 Amps peak to peak |
| Damping factor | 150 |
| Gain (volume max) | 32dB (Direct Mode), 42dB (Normal Mode) |
| Output devices | 2 per channel |

THD+N

< 0.05% typical
< 0.01% A-wtd.

Signal / noise ratio

82dB

Channel separation

85dB

Frequency response

+ 0, -1dB, 10Hz to 40 kHz

Line level sensitivity

300mV rms nominal

8V rms max

Line level inputs impedance

25k Ohms

Tape Out impedance

220 Ohms

Pre Out impedance

100 Ohms

Phono RIAA response

+/- 1dB

MM sensitivity

5mV nominal

MM capacitance / impedance / gain

100pF / 50k Ohms / 40dB

MM signal / noise ratio

75dB

MC sensitivity

450µV nominal

MC impedance / gain

1k Ohm / 60dB

MC signal / noise ratio

70dB

Connections

Phono input MM/MC

1 pair RCA connectors and ground post

Line level inputs

5 pairs line level RCA connectors

Line level outputs

1 pair line level RCA connectors, TAPE OUT fixed level

1 pair line level RCA connectors, PRE OUT variable level

Speaker outputs

2 pairs 4mm banana plug/binding posts

Power requirement

Mains voltages

115/230VAC 50/60Hz (factory pre-set)

100VAC 50/60Hz (alternative)

Consumption

0W in standby (= Power Switch OFF)

130W maximum

Weight

Unit only, unboxed

10.5 kg

in shipping carton

12 kg

Maximum Dimensions

Wide

440 mm

Height

68.3 mm

Deep (front to back) including terminals

283.3 mm

Standard accessories

IEC type mains lead

10-Amp type

Remote control

A1 remote

Batteries

CR2032

Musical Fidelity reserves the right to make improvements which may result in specification or feature changes without notice.



RELEASE

DATE

CHANGES

A1

24th May 20233rd issue, Specs adjustedDISPOSAL

The crossed out wheeled bin label that appears on the back panel of the product indicates that the product must not be disposed of as normal household waste. To prevent possible harm to the environment please separate the product from other waste to ensure that it can be recycled in an environmentally safe manner. Please contact local government office or retailer for available collection facilities.

DISPOSITION

La poubelle sur roulettes barrées X, qui apparaît en logo sur le panneau arrière du produit, indique que celui-ci ne doit pas être traité comme un déchet domestique commun. Afin de protéger l'environnement, ce produit électronique devra être géré séparément et donc recyclé selon les nouvelles normes Européennes Rohs concernant les déchets d'appareils électroniques. Prière de contacter les services concernés gouvernementaux ou votre point de vente pour l'élimination et l'enlèvement de déchets électroniques équipés de composants électroniques.

DISPOSAL

La etiqueta cruzada hacia fuera del compartimiento que aparece en el panel trasero del producto indica que el producto no se debe reciclar como basura normal de la casa. Para prevenir daños posible al ambiente separe por favor el producto de otra basura para asegurarse de que puede ser reciclada de una manera ambientalmente segura. Entre en contacto por favor a su oficina gubernamental local o a su minorista para las instalaciones disponibles de la colección.

RIFIUTI

L'etichetta del cassonetto barrato riportato sul retro dell'apparecchio indica che il prodotto non deve essere smaltito tramite la procedura normale di smaltimento dei rifiuti domestici. Per evitare eventuali danni all'ambiente, separare questo prodotto da altri rifiuti domestici in modo che possa venire riciclato in base alle procedure di rispetto ambientale. Per maggiori dettagli sulle aree di raccolta disponibili, contattate l'ufficio governativo locale od il rivenditore del prodotto.

FACHGERECHTE ENTSORGUNG:

Das auf der Geräterückseite angebrachte Label deutet darauf hin, dass das Produkt nicht mit konventionellem Hauskehricht entsorgt werden darf. Um Schäden und Verschmutzungen an Umwelt und Mensch zu vermeiden, muss das Produkt fachgerecht entsorgt und von anderem Abfall getrennt werden. Wenden Sie sich bei Fragen hierzu an Ihren Fachhändler oder an eine öffentliche Informationsstelle.

AFVAL

Het label op de achterzijde van dit apparaat, een afvalbak op wielen met een kruis doorgehaald, geeft aan dat dit apparaat niet samen met gewoon huishoudafval mag worden weggegooid. Om mogelijke schade aan onze leefomgeving te voorkomen dient dit apparaat, gescheiden van gewoon huishoudelijk afval, te worden afgevoerd zodat het op een milieuvriendelijke manier kan worden gerecycled. Neem voor beschikbare inzamelplaatsen contact op met uw gemeentelijke reinigingsdienst of met uw elektronica leverancier.



Yliuksattua jäteastiaa kuvaava tarra tuotteen takalevyssä kertoo, että tuotetta ei saa käsitellä normaalina talousjätteenä. Ympäristön suojelemiseksi on tuote pidettävä erillään muusta jätteestä ja se on kierrätettävä ekologisesti kestävällä tavalla. Ota yhteyttä laitteen myyjään tai Pirkanmaan Ympäristökeskukseen lähimmän kierrätyskeskuksen löytämiseksi.

HÄVITTÄMINENAFSKAFNING

Logoet med en skraldespand med kryds over på bagsiden af apparatet indikerer at dette produkt ikke må kasseres som normal husholdningsaffald. For at forebygge mulig skade på miljøet, bedes De separere dette produkt fra andet affald, og sikre at det bliver genbrugt på en miljørigtig måde. Kontakt venligst de lokale myndigheder eller din forhandler for oplysning om nærmeste tilgængelige opsamlingssted for elektronikaffald.

ΔΙΑΔΙΚΑΣΙΑ ΑΠΟΡΡΙΨΗΣ

ΤΟ ΣΗΜΑ ΜΕ ΤΟΝ ΔΙΑΓΕΓΡΑΜΜΕΝΟ ΤΡΟΧΗΛΑΤΟ ΚΑΔΟ ΑΠΟΡΡΙΜΑΤΩΝ ΣΤΗΝ ΠΙΣΩ ΟΨΗ ΤΟΥ ΜΗΧΑΝΗΜΑΤΟΣ

ΔΗΛΩΝΕΙ ΟΤΙ ΤΟ ΠΡΟΙΟΝ ΑΥΤΟ ΔΕΝ ΠΡΕΠΕΙ ΝΑ ΔΙΑΧΕΙΡΙΣΘΕΙ ΣΑΝ ΣΥΝΗΘΙΣΜΕΝΟ ΟΙΚΙΑΚΟ ΑΠΟΒΛΗΤΟ.

ΠΡΟΣ ΑΠΟΦΥΓΗ ΕΝΔΕΧΟΜΕΝΗΣ ΕΠΙΒΑΡΥΝΣΗΣ ΤΟΥ ΠΕΡΙΒΑΛΛΟΝΤΟΣ, ΞΕΧΩΡΙΣΤΕ ΤΟ ΠΡΟΙΟΝ ΑΠΟ ΤΑ ΑΛΛΑ ΑΠΟΡΡΙΜΑΤΑ ΩΣΤΕ ΝΑ ΕΞΑΣΦΑΛΙΣΘΕΙ Η ΑΝΑΚΥΚΛΩΣΗ ΤΟΥ ΜΕ ΤΟΝ ΠΡΕΠΟΝΤΑ ΤΡΟΠΟ.

ΠΑΡΑΚΑΛΟΥΜΕ ΝΑ ΕΠΙΚΟΙΝΩΝΗΣΕΤΕ ΜΕ ΤΗΝ ΤΟΠΙΚΗ ΥΠΗΡΕΣΙΑ ΑΝΑΚΥΚΛΩΣΗΣ Η ΜΕ ΤΟ ΚΑΤΑΣΤΗΜΑ ΑΓΟΡΑΣ ΓΙΑ ΠΕΡΙΣΣΟΤΕΡΕΣ ΛΕΠΤΟΜΕΡΕΙΕΣ.